

# Our City

HALIFAX

## Halifax facts

- ✘ Halifax is the capital of Nova Scotia
- ✘ Business, financial, educational, social and cultural centre for Canada's East Coast
- ✘ Population: over 380,000 people – growth is 1% per year
- ✘ Smart city: six universities and 35,000 students who receive over 1 million dollars in research and development funding annually
- ✘ Climate: no extremes of hot or cold due to our location on the gulf stream



## Heritage and Culture

- ✘ Vibrant arts and culture environment: symphony, theatre, art galleries, museums, historic sites
- ✘ Variety of recreation: parks, beaches, hiking, boating, golf
- ✘ Over 450 dining establishments and exciting nightlife, many with live local entertainment
- ✘ Known for abundant fresh local seafood
- ✘ More pubs and bars per capita than any city in Canada

## Getting here is the easy part

- ✘ Easy access via Land, Rail, Sea or Air
- ✘ Robert L. Stanfield International Airport is the hub for travel in Atlantic Canada
  - ✘ U.S. pre-clearance
  - ✘ Scheduled service to all major Canadian Cities
  - ✘ Direct flights to major hubs in the US and Europe – Washington, Chicago, Newark, JFK, LaGuardia, Boston and London

# Our Facility

## World Trade and Convention Centre



- ✘ Centrally located in downtown Halifax and within walking distance to hotels, restaurants and attractions
- ✘ Combines elegant world class facilities, comprehensive services and the natural hospitality for which Maritimers have long been known
- ✘ Three floors of flexible and multi-purpose meeting and banquet rooms
- ✘ More than a dozen rooms accommodating up to 3,000 people for banquets and receptions
- ✘ Spectacular harbour views from *Windows at the World Trade Centre* restaurant
- ✘ Connected via the Downtown Halifax Link to over 1,000 four-diamond guest rooms and within walking distance to another 1,600 hotel rooms
- ✘ Fully integrated with the World Trade and Convention Centre is the 10,000 seat Halifax Metro Centre, a major full service trade show, exposition, sporting event and entertainment facility
- ✘ Parking for approximately 2,600 vehicles within the Downtown Halifax Link system
- ✘ Wireless internet service available, fibre optic cable, video conferencing and satellite link capabilities
- ✘ Official suppliers available to assist you: AVW Tel AV and Global Convention Services
- ✘ Eco-friendly programs

# Our Eco-friendly Program

## Minimizing our impact on the environment

In Halifax, with our dramatic coastline and refreshing salt-sea air, the environment is so important to who we are as people, that as meeting and event hosts we really want to ensure we're doing our very best to take care if it.

The Halifax World Trade and Convention Centre has implemented an array of eco-friendly programs to minimize our impact on the environment while providing the best meetings, conferences, trade shows and events on Canada's East Coast. These include:



- ✘ HVAC air filtration system
- ✘ New CO, CO2 and NO sensors monitor indoor and outdoor air quality
- ✘ Digital temperature controls
- ✘ Water-conserving fixtures and equipment help reduce water consumption levels
- ✘ Energy-efficient lighting, including occupancy sensors in every meeting and banquet room
- ✘ Adherence to a strict environmental policy for the purchase of products and equipment: all cleaning products, for example, are Eco Logo or Green Seal-certified
- ✘ Stationery is printed on FSC-certified paper stock
- ✘ Stringent protocols are used for safely disposing of hazardous and chemical waste
- ✘ All operations participate in our Solid Waste Management Program, separating paper products and blue-bag recyclables from regular refuse, and composting all organic materials
- ✘ Waste-separation containers are provided in all public areas of the facility to encourage visitors to participate
- ✘ Menus featuring seasonal, regionally available and organic culinary products, all free of trans-fats, are offered
- ✘ Meals and snacks are presented on porcelain rather than disposable dishware
- ✘ Refillable water jugs are offered instead of bottled water

# Our Floor Plans

## Level One

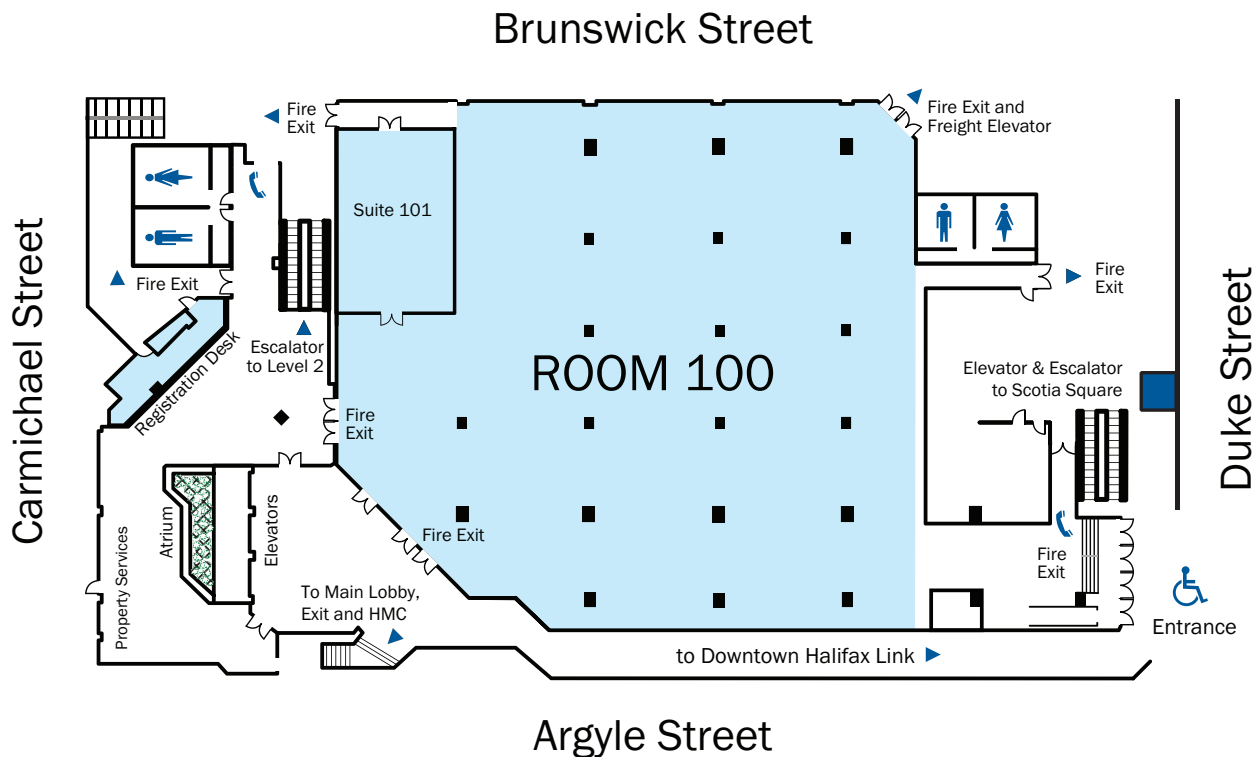

### CAPACITIES

Section	Ft <sup>2</sup>	M <sup>2</sup>	TH	CL	BR	BQT	D/D	RCPT	U	HS
Room 100	13,000	1,207	-	-	-	950	830	1,200	-	-
Suite 101	1,260	117	110	45	26	80	-	100	33	34
Registration/ Level 1 Atrium	2,617	243	-	-	-	-	-	-	-	-

### Trade Show Setup

Capacity of Level One Room 100: 74\* - 10'x 10' booths

\*No food and beverage space available at maximum capacity.

### Legend

BQT - Banquet Ovals of 10	BR - Boardroom	CL - Classroom	D/D - Dinner/Dance Ovals of 10	HS - Hollow Square
MIL - Military	RCPT - Reception	TH - Theatre	U - U shape	

# Floor Plans

FLOOR PLANS

## Level Two

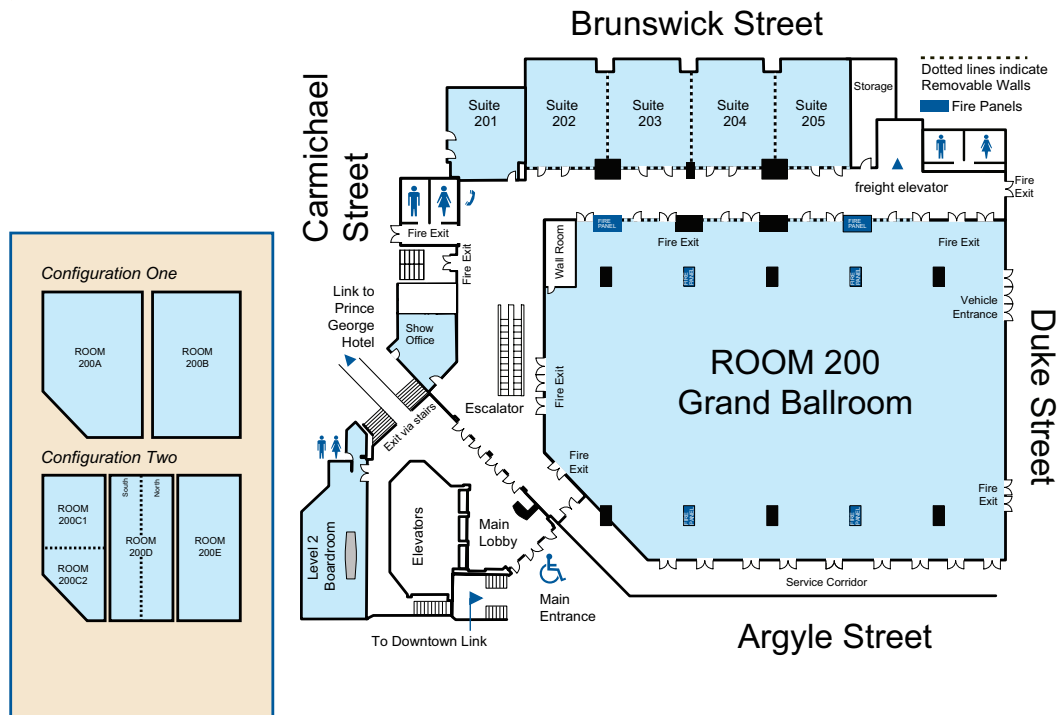

### CAPACITIES: Suites 201-205

Section	Ft <sup>2</sup>	M <sup>2</sup>	TH	CL	BR	BQT	D/D	RCPT	U	HS
Boardroom	1,100	102.2	-	-	14/22	14	-	50	-	-
Suite 201	730	67.8	60	27	20	40	-	50	20	26
Suite 202/03/04/05	1,060	98.4	78	36	22	60	-	70	24	32
Suite 202 & 203/ 203 & 204/ 204 & 205	2,120	196.9	164	65	-	120	-	150	45	58
Suite 202-204/ 203-205	3,180	295.4	315	102	-	180	150	225	67	75
Suite 202-205	4,240	393.9	410	-	-	270	210	300	-	-
Show Office	500	46.4	-	-	-	-	-	-	-	-

### Trade Show Setup

Capacity of Level Two Suites: 24\* - 10' x 10' booths

\*No food and beverage space available at maximum capacity.



Come check us out at [wtcchalifax.com](http://wtcchalifax.com)

# Floor Plans

FLOOR PLANS

## Level Two

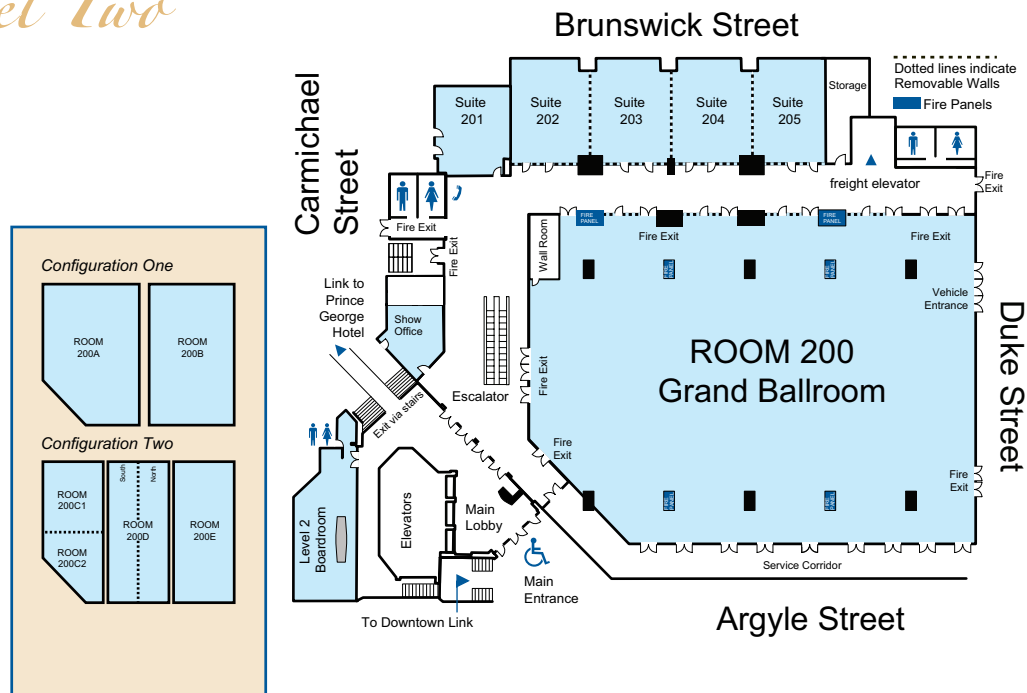

### CAPACITIES: Room 200

Section	Ft <sup>2</sup>	M <sup>2</sup>	TH	CL	MIL	BQT	D/D	RCPT	U	HS
Room 200 - Grand Ballroom	20,000	1,858	1,580	703	1,400	1,000	780	2,000	117	142
Room 200A	9,600	891.8	700	277	550	460	320	600	84	112
Room 200B	10,500	975.4	750	280	650	480	320	700	90	118
Room 200C	5,680	527.6	450	160	350	240	200	400	69	82
Room 200C1	3,100	287.9	215	75	-	130	120	200	42	52
Room 200C2	2,580	239.6	198	77	-	110	90	150	33	40
Room 200D	7,650	710.7	530	242	400	300	200	450	75	94
Room 200E	6,850	636.3	495	232	400	300	200	450	72	88
Room 200C & 200D	13,330	1,238.3	1,000	414	730	650	440	1,000	94	118
Room 200D & 200E	14,500	1,347.1	1,008	420	750	660	510	1,200	93	124
Room 200D - South	3,820	354.8	200	80	-	180	120	270	66	74
Room 200D - North	3,820	354.8	200	80	-	180	120	270	66	74

### Trade Show Setup

Capacity of Level Two Room 200: 89\* - 10' x 10' + 7 - 10' x 8' booths  
 \*No food and beverage space available at maximum capacity.

Come check us out at [wtcchalifax.com](http://wtcchalifax.com)



# Floor Plans

FLOOR PLANS

## Level Three

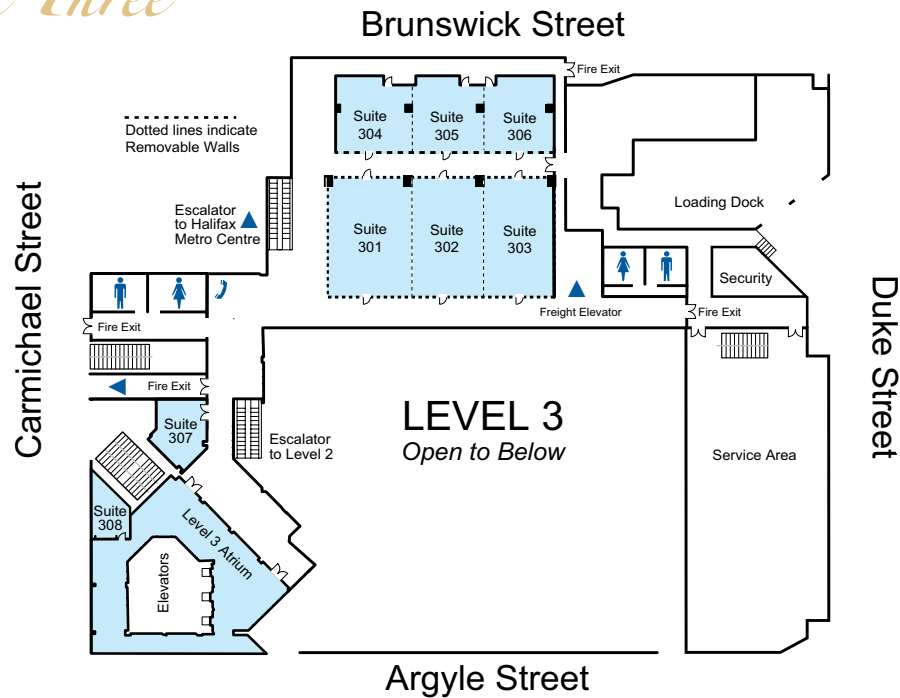

### CAPACITIES: Suites & Atrium

Section	Ft <sup>2</sup>	M <sup>2</sup>	TH	CL	MIL	BQT	D/D	RCPT	U	HS
Room 300 (Suites 301-306)	8,640	803.6	-	-	-	550	380	750	-	-
Suite 301/302/303	1,500	139.3	134	50	-	80	-	125	36	46
Suite 301 & 302/302 & 303	3,000	278.7	294	100	-	160	120	250	65	80
Suite 301 - 303	4,500	418	390	158	-	280	190	375	85	100
Suite 304/305/306	930	86.4	70	26	22	40	-	50	21	28
Suite 304 & 305/305 & 306	1,860	172.8	104	34	-	100	-	100	-	-
Suite 304 - 306	2,790	259.2	-	-	-	140	-	150	-	-
Suite 301 & 304/302 & 305/ 303 & 306	2,430	225.7	290	114	-	120	-	175	77	84
Room 300 - South (Suites 301, 302, 304 & 305)	4,860	451.5	-	-	-	380	-	350	-	-
Room 300 - North (Suites 302, 303, 305 & 306)	4,860	451.5	-	-	-	380	-	350	-	-
Suite 307	600	55.7	32	10	16	30	-	40	16	18
Suite 308	-	-	-	-	10	-	-	-	-	-
Level 3 Atrium	2,200	204.3	-	-	-	60	-	250	-	-

### Trade Show Setup

Capacity of Level Three Room 300: 50\* - 10' x 10' booths

\*No food and beverage space available at maximum capacity.

Come check us out at [wtcchalifax.com](http://wtcchalifax.com)

# Floor Plans

## Level Eight

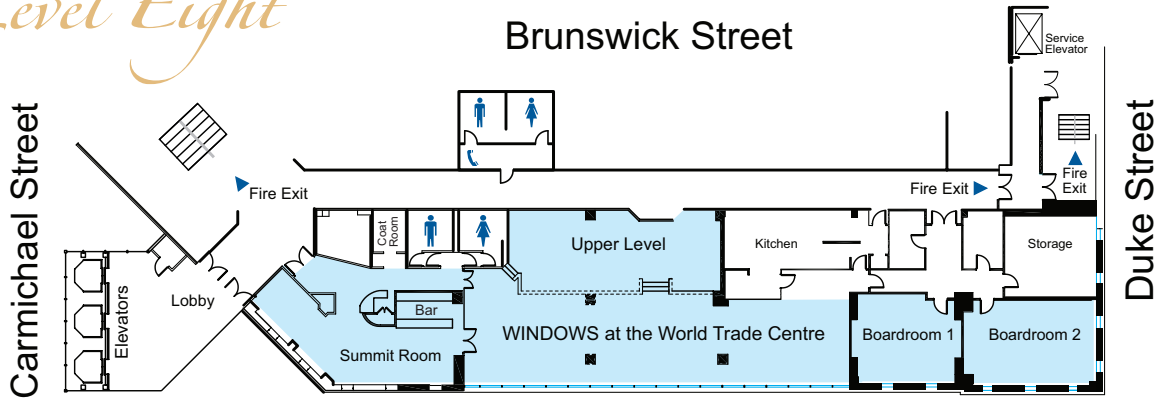

## Argyle Street

CAPACITIES: Restaurant & Meeting Rooms

Section	Ft <sup>2</sup>	M <sup>2</sup>	TH	CL	BR	BQT	D/D	RCPT	U	HS
Boardroom 8A	440	40.9	-	-	12/16	-	-	-	-	-
Boardroom 8B	530	49.2	-	-	18/24	-	-	-	-	-
Windows Restaurant	2,592	240.8	70	35	24	170	120	250	22	24
Summit Room	628	58.3	-	-	-	40	-	60	-	-

## Halifax Metro Centre

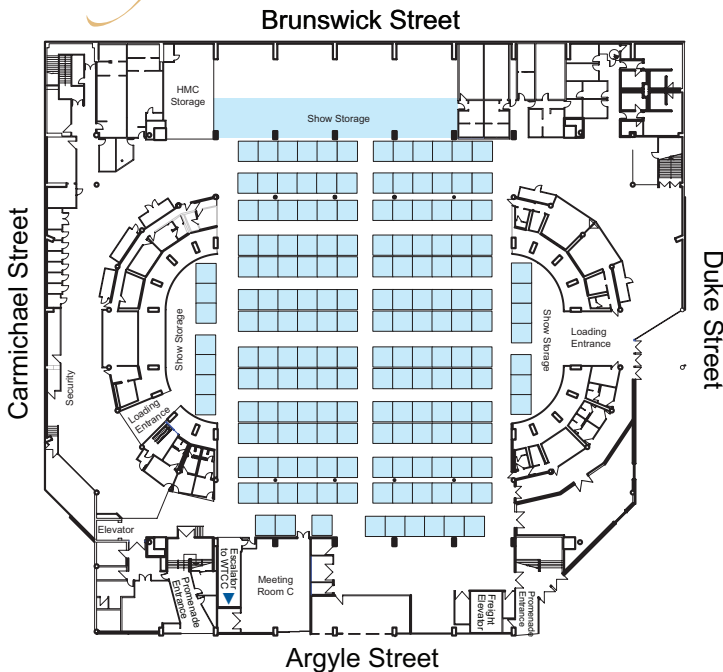

CAPACITIES: Halifax Metro Centre

Section	Ft <sup>2</sup>	M <sup>2</sup>	TH	BQT
Halifax Metro Centre	40,000	3,716	10,000	2,500

Event Setup  
Setup varies with event.

Trade Show Setup (left)  
Capacity: 176\* - 10' x 10' booths  
\* No food and beverage space available at maximum booth capacity.



# Our City Maps

## Downtown Halifax Link Map

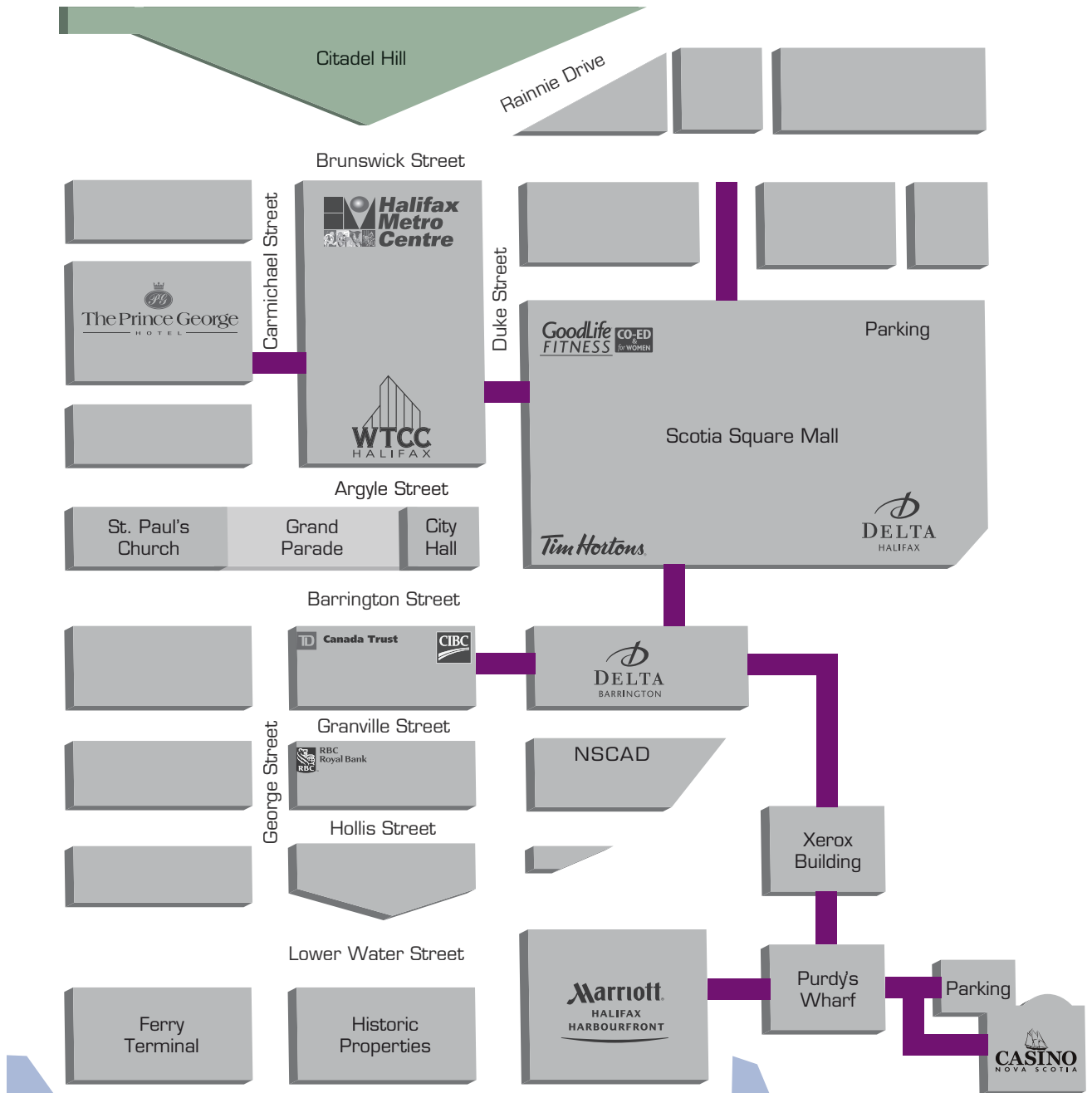

# Our City Maps

## Downtown Halifax

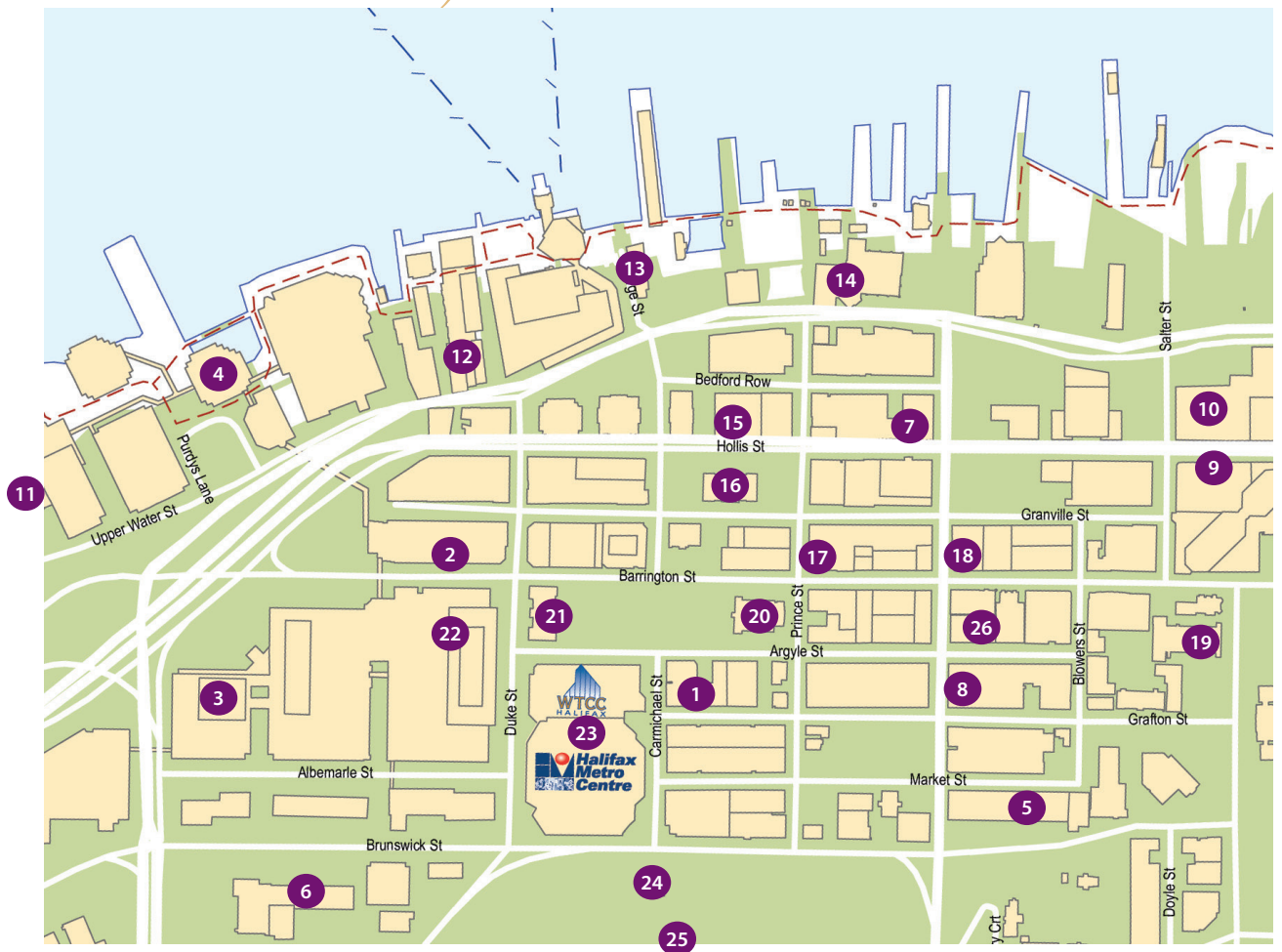

### Hotels

1. The Prince George Hotel
2. Delta Barrington
3. Delta Halifax
4. Halifax Marriott Harbourfront Hotel
5. Cambridge Suites Hotel
6. Citadel Halifax Hotel
7. Radisson Suite Hotel Halifax
8. Residence Inn by Marriott
9. Four Points by Sheraton Halifax
10. Courtyard by Marriott

### Attractions

11. Casino Nova Scotia
12. Historic Properties
13. Nova Scotia Crystal
14. Maritime Museum of the Atlantic
15. Art Gallery of Nova Scotia
16. Province House
17. Nova Scotia Centre for Craft & Design
18. Discovery Centre
19. Saint Mary's Basilica
20. Saint Paul's Anglican Church
21. Halifax City Hall
22. Scotia Square Visitor Information Centre
23. Nova Scotia Sport Hall of Fame
24. Old Town Clock
25. Halifax Citadel National Historic Site of Canada
26. Neptune Theatre

